



Electro-hydraulic 2 post lift  
Capacity 4 T

**KPH370.42K MB**

Dokumentennummer: 009357 PB RAV KPH370.42KMB-4t



S224A3



S224A4



S370A19

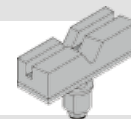

S305A4



S370A27



S370A22



S370A23

Art. No.	Q.ty	Description
		<b>KPH370.42KMB</b> Electro-hydraulic 2 post lift, capacity 4 T <i>Supplied with the lift:</i>
S224A3	Set of 4	Quick drop-in spacers H= 80 mm
S224A4	Set of 4	Quick drop-in spacers H= 140 mm
S370A19	Set of 4	Set of supports for chassis lifting
		<i>Accessories on request:</i>
S305A4	Set of 4	V-shaped supports (adjustable H=150/190mm)
S370A27	Set of 2	Bowls
S370A22	1	Belts kit
S370A23	Set of 4	Set of ramps for extra low vehicles



Electro-hydraulic 2 post lift  
 Capacity 4 T

**KPH370.42K MB**

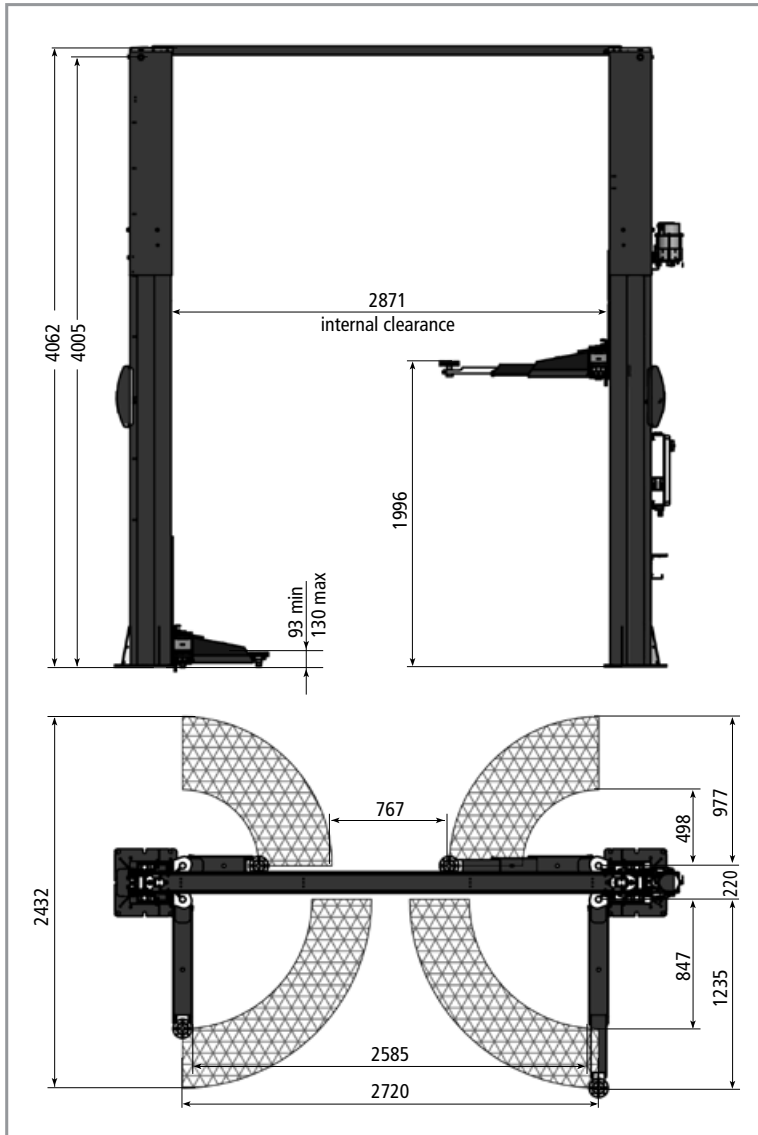

**ENERGY KIT**

- 2 compressed air quick connections
- 1 electric plug Schuko 220V single phase

